

Handle system for universal installation

Note:

For reasons of clarity of the presentation, these operating instructions do not contain all information details and also cannot cover every possible case of installation, operation or repair. Technical specifications are subject to change without notice. In case of doubt, the German text prevails.

Sensor unit:

Access Unit 7320.220

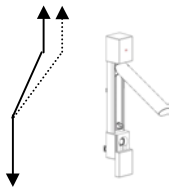

Pin configuration for connecting cable

RJ12 plug handle:

Pin1: white	free
Pin2: brown	Gnd
Pin3: green	Code 1
Pin4: yellow	Code 2
Pin5: grey	interlocking coil
Pin6: pink	handle sensor

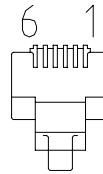
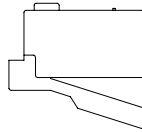

Warning: Start-up:

Please ensure that the handle can be opened via the electrical system after locking. The handle can only be open electronically. If this is not possible, an emergency opening must be made. For this purpose the handle must be processed mechanically.

Description:

The electro-magnetic handles can be connected to the Access Unit 7320.220 (max. 2). The handle functions as a door interlock and grip lever monitor. An access sensor for each handle must be mounted on the controlled door. If the grip lever are closed, the interlock coil integrated in the handle locks automatically. The handle can be released through the CMC-TC system in the network or through optional extra systems, e.g., a chip card reader (7320.750), magnetic card reader (7320.760), number code lock (7320.770) or an individually settable floating switching contact (7320.580).

Attention. The handle open by an electrical connection, only. By open the handle it's necessary to have a release by the electrical CMC-TC and by the push-button.

The handle is assigned a code to ensure that it is identified and set up automatically by the CMC-TC system. The following components are required for operating the handle:

- Processing Unit (7320.100) min. SW V 1.1 with mains adapter (e.g., 7320.425), connecting cable complying with local specifications, programming cable.
- Sensor unit (7320.220) min. SW V 1.1, connecting lead (RJ45, Cat5).
- Access sensor (7320.530)

General conditions of use:

- The handle must only be used together with the Rittal CMC-TC system.
- The operating instructions / safety instructions of the Processing Unit and of the above sensor units apply.
- The maximum cable length between the sensor unit and the handle is 3+2m. The connection must be made with the connecting cable of the supply. Extension cables 7200.450 for special applications are available after consultation with our central office.
- It is absolutely necessary that these cables are installed separately from mains power cables.
- The use of the handles are exclusively limited to the specified ambient conditions.
- It is forbidden to open the handle housing. They do not contain parts requiring maintenance.
- Before making the connection, check to be sure that the handle can be used with the device / module.
- It is forbidden to render safety equipment ineffective.
- Direct contact of the handle with water (e.g., dew), oil sludge or any aggressive substances is forbidden.
- Use in locations with flammable gas or vapour is forbidden. Protection from water, dust, etc. must be ensured by installation in a enclosure or rack.
- The CMC-TC system must not be live with voltage when the handle is being connected to the sensor unit.
- The handle must be installed properly as described in the separate installation instructions.

Technical data:

Coil voltage 24 V DC
Coil current consumption 100 mA
Connecting cable: length 3 m, RJ12 plug
Extension cable: length 2 m, RJ12/RJ12 plug

Coupler for extension: RJ12/RJ12 socket
Temperature range: +5°C to +40°C
Protection category: IP40 by fit condition

Address: Rittal GmbH & Co. KG / Auf dem Stützberg / D-35745 Herborn / Tel: (+49) (2772) 505 – 0 /
Fax: (+49) (2772) 505 – 2319 / eMail: Info@rittal.de / Internet: <http://www.rittal.de>



You need a torx screwdriver for installation.

Caution!! Install the handle while the enclosure door is open!!! Make a function check of the handle while the enclosure door is open!!! Do not close the enclosure door while installing the handle!!!

Install the enclosure door handle as follows:

Prepare the enclosure door by making the openings in the door frame with the template below (see illustration) (unless already provided because these are standard openings).

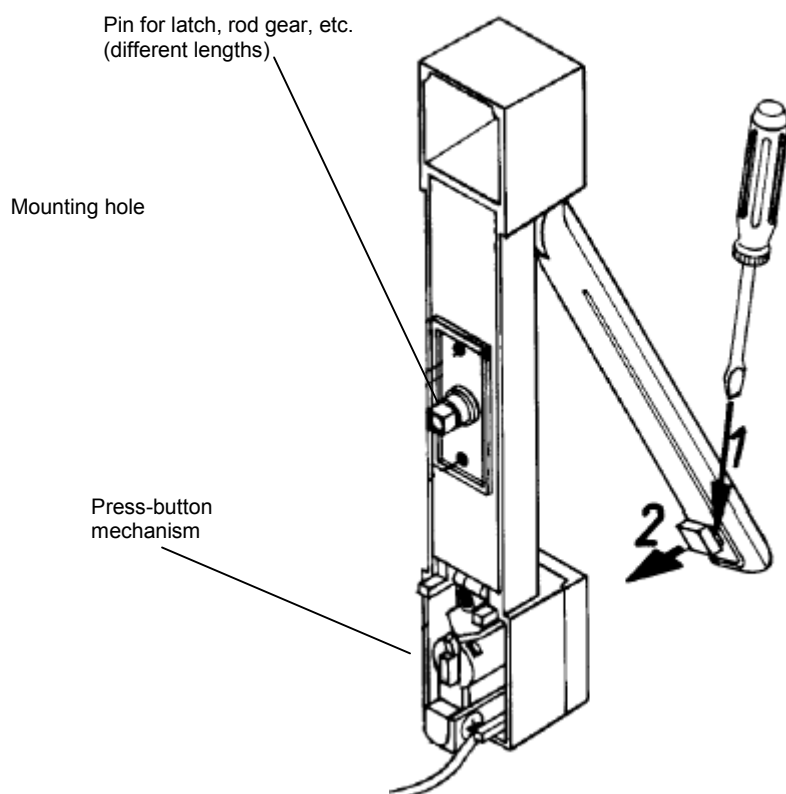
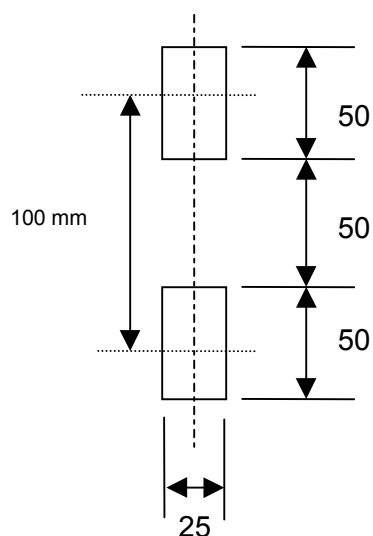

1. At first pull the O-ring to fit the mound of the handle pin.
2. Next, insert the enclosure handle in the mounting hole from outside (exploded view)
3. Insert the pin in the rod gear.
4. Next, push the seal, then the covers on the handle (as shown in the exploded drawing).
5. Then tighten 4 screws

Installation for latch fastening and round linkage (not shown) with long pin

Caution!!! Install the handle while the enclosure door is open!!! Make a function check of the handle while the enclosure door is open!!! Do not close the enclosure door while installing the handle! After the appropriation, you can remove the **security element 2** by the **screwdriver1**.

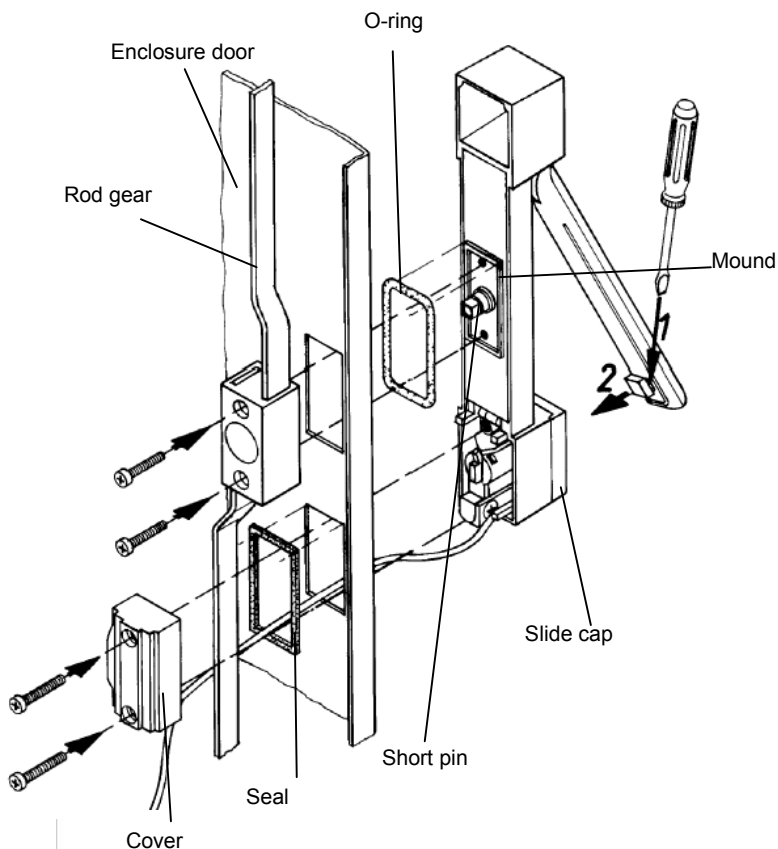
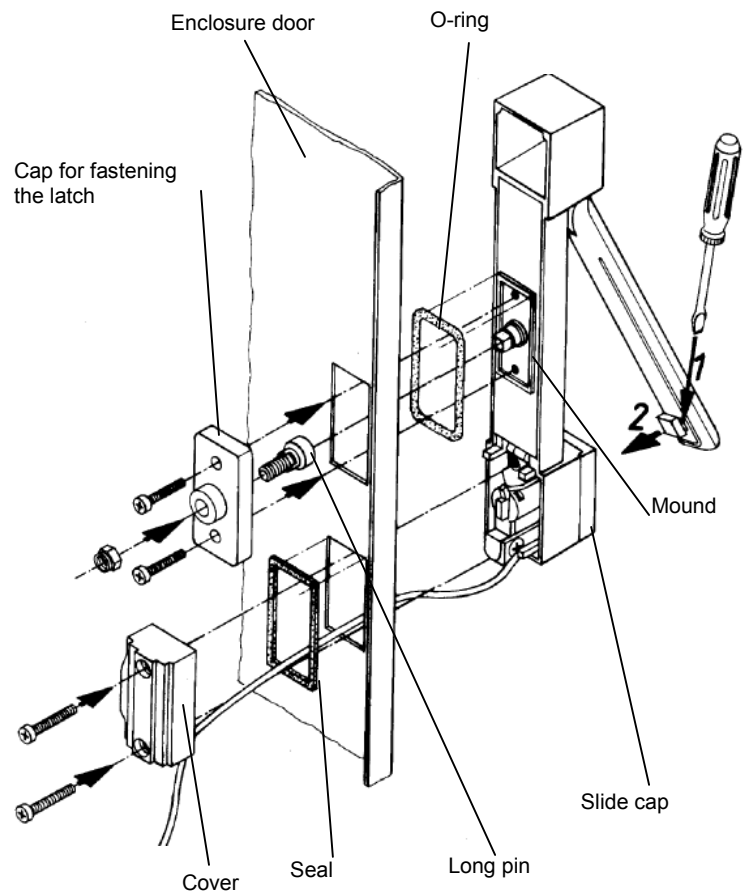

Installation with flat linkage (short pin)

Caution!!! Install the handle while the enclosure door is open!!! Make a function check of the handle while the enclosure door is open!!! Do not close the enclosure door while installing the handle! After the appropriation, you can remove the **security element 2** by the **screwdriver1**.