

Voltage Detector

DK 7320.600

Note:

For reasons of clarity of the presentation, these operating instructions do not contain all information details and also cannot cover every possible case of installation, operation or repair. Technical specifications are subject to change without notice. In case of doubt, the German text prevails.

Sensor unit:
I/O Unit 7320.210

Sensor unit:
Climate Unit 7320.230

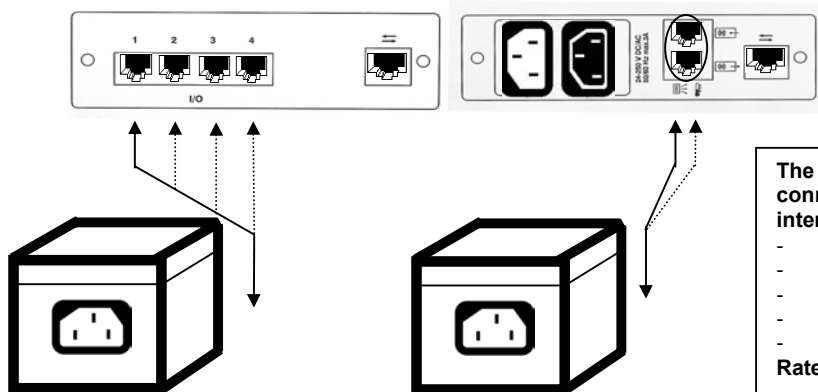

The voltage detector must be connected with an IEC connection cable. This voltage is monitored for interruption.

- 7200.210 Connecting cable design D / F / B
- 7200.211 Connecting cable design GB
- 7200.213 Connecting cable design CH
- 7200.214 Connecting cable design USA / CDA
- 7200.215 Connecting cable design IEC

Rated voltage 230 V AC 50/60 Hz

Description:

The voltage detector may be connected to the I/O Unit 7320.210 (max. 4 detectors) or to the Climate Unit 7320.230 (max. 2 detectors). The voltage detector measures a mains voltage by using a connection cable. The message has two different states, Voltage „On“ and Voltage „Off“. The voltage detector is assigned a code by which it is automatically identified and set by the CMC TC system. The sensor can be used if the following components are available:

- Processing Unit (7320.100) with mains adapter (e.g., 7320.425), national-standard connecting cable, programming cable.
- Sensor unit (7320.210 or 7320.230), Connecting Cable (RJ45, Cat5).

General conditions of use:

- The voltage detector must only be used together with the Rittal CMC-TC system.
- The operating instructions / safety instructions of the Processing Unit and of the above sensor units apply.
- The maximum cable length between the voltage detector and the sensor is 2m. The connection must be made with the connecting cable of the supply. Extension cables 7200.450 for special applications are available after consultation with our central office.
- It is absolutely necessary that these cables are installed separately from mains power cables.
- The use of the voltage detector is exclusively limited to the specified ambient conditions.
- It is forbidden to open the detector enclosures. They do not contain parts requiring maintenance.

Caution! Due to the IEC connection, very high tension is supplied to the system. There is danger when the system is opened.

- Before making the connection, check to be sure that the voltage detector can be used with the device / module.
- It is forbidden to render safety equipment ineffective.
- Direct contact of the voltage detector with water (e.g., dew), oil sludge or any aggressive substances is forbidden.
- Use in locations with flammable gas or vapor is forbidden. Protection from water, dust, etc. must be ensured by installation in a cabinet or rack.
- The CMC-TC system must not be live with voltage when the voltage detector is being connected to the sensor unit.
- The detector must be installed properly as described in the separate installation instructions.

Technical data:

Monitored rated voltage: 230 V AC 50/60 Hz
Connection: RJ12 socket 6-pole
Connecting cable: length 2m, RJ12 socket 6/6 both ends
Temperature range: +5°C to +45°C
Protection category: IP40

Address: Rittal GmbH & Co. KG / Auf dem Stützberg / D-35745 Herborn / phone: (+49) (2772) 505 – 0 /
Fax: (+49) (2772) 505 – 2319 / eMail: Info@rittal.de / Internet: <http://www.rittal.de>

